

TYPICAL TEST RESULT

IMPACT LnTW = 50dB      AIRBORNE DnTW = 56dB      DnTW + CTR = 53dB

18mm CHIPBOARD, ALL TEEGEE JOINTS GLUED USING HUSH-BOND AND SEALED TO ALL PERIMETERS USING HUSH-SEAL 20. LAID OVER 47mm x 50mm TIMBER BATTENS. SUPPORTED BY HUSH-CRADLES AT 450mm CENTRES AND HEIGHT ADJUSTED. HUSH-SLAB 75 FITTED BETWEEN HUSH-CRADLE AND BATTEN RUNS, ON TOP OF EXISTING 22mm FLOORBOARDS. MF CEILING SYSTEM SUSPENDED FROM UNDERSIDE OF JOISTS CREATING 300mm VOID. 2 LAYERS OF 12.5mm GYPROC FIRELINE PLASTERBOARD SECURED TO MF CEILING HANGERS WITH HUSH-SLAB 100 FITTED INBETWEEN OVER BACK OF CEILING. PROVIDES 1 HOUR FIRE RESISTANCE AT CEILING LEVEL.

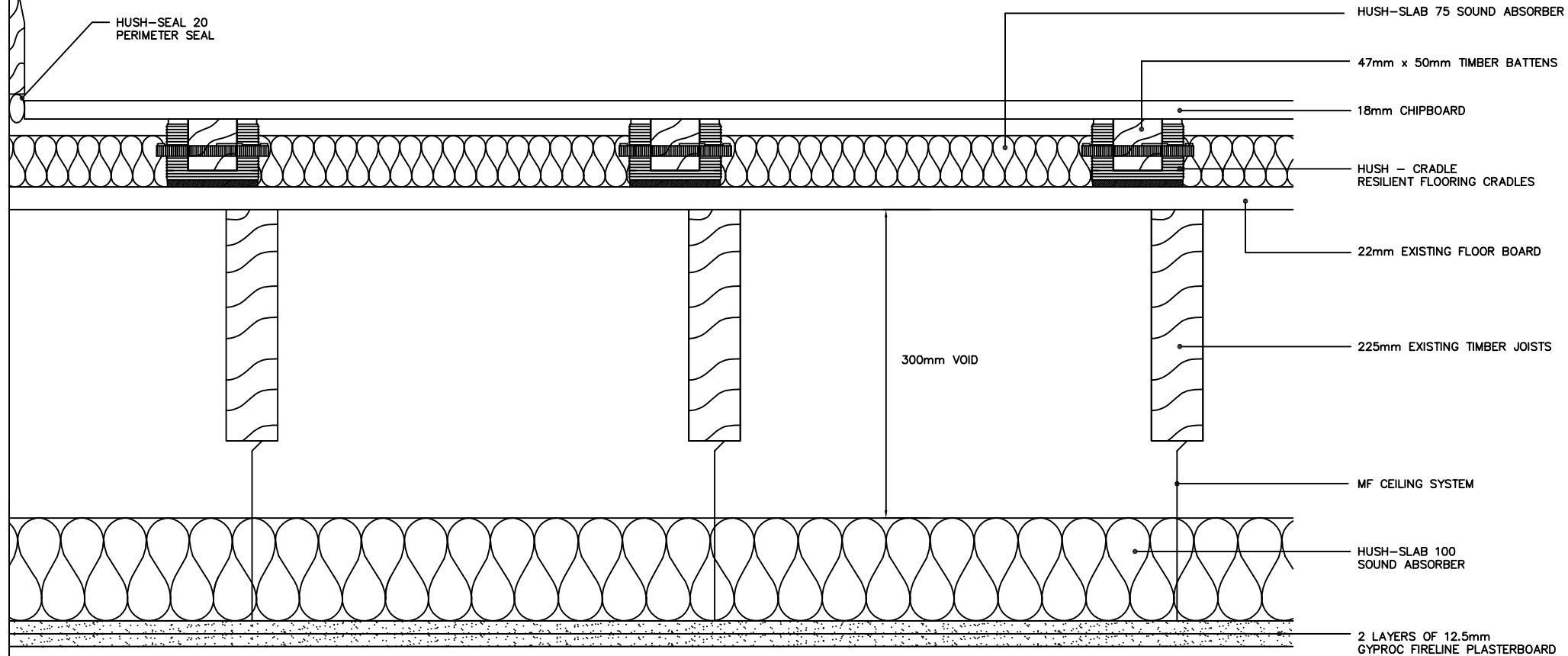

HUSH (UK) LTD  
HUSH-CRADLE SYSTEM  
TYPE HD1031